

Rotec Brides tubulées

Bride fixe tubulée

Drilling Standard: ANSI B16.5 Class 150, Resin Type: Derakane 470

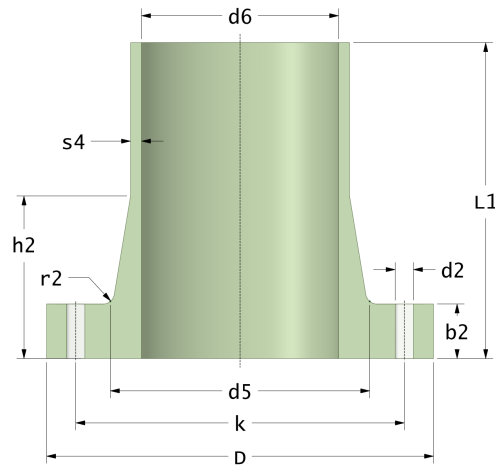

#	DN (mm)	Pmax (bar)	D (mm)	d6 (mm)	d5 (mm)	r2 (mm)	s4 (mm)	k (mm)	Holes (no.)	d2 (mm)	L1 (mm)	h2 (mm)	b2 (mm)	Article Number
1	100	16	228	100	133	2	6	190	8	19	300	55	25	TFC-100-300/150
2	200	10	342	200	237	4	6	298	8	22	360	85	25	TFC-200-360/150
3	250	10	405	250	293	5	7	362	12	25	360	100	28	TFC-250-360/150
4	400	10	600	400	451	8	8	540	16	29	360	150	40	TFC-400-360/150

Disclaimer

Whilst every care is taken to ensure that the information on this website is complete and accurate, the Rotec Composite Group BV cannot accept responsibility for any omissions or inaccuracies or for any consequences arising therefrom. By using this website, the user accepts the terms of this disclaimer.