

Fixed Flanges

Adhesive bonded Fixed Flange (Flat Face) for GRP pipe

Drilling Standard: JIS B2220 30K

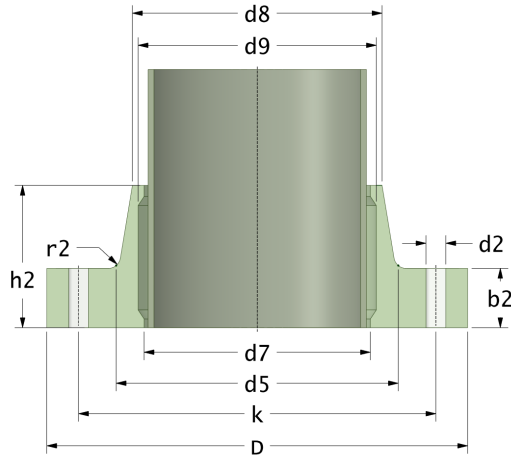

#	DN (mm)	Pmax (bar)	D (mm)	d7 (mm)	d9 (mm)	d8 (mm)	d5 (mm)	r2 (mm)	k (mm)	Holes (no.)	d2 (mm)	h2 (mm)	b2 (mm)	Article Number
1	150	25	325	167	171	178	194	16	275	12	27	94	44	FF-150-25/30K
2	150	32	325	167	171	178	194	16	275	12	27	101	51	FF-150-32/30K
3	200	25	380	221	225	230	246	11	320	12	27	118	56	FF-200-25/30K
4	200	32	380	221	225	230	246	11	320	12	27	128	66	FF-200-32/30K
5	250	25	450	273	277	288	298	12	390	12	33	128	68	FF-250-25/30K
6	250	32	450	273	277	288	298	12	390	12	33	141	81	FF-250-32/30K
7	300	25	540	326	330	338	356	16	450	16	33	155	80	FF-300-25/30K
8	300	32	540	326	330	338	356	16	450	16	33	171	96	FF-300-32/30K
9	350	25	585	378	382	390	406	12	495	16	33	182	92	FF-350-25/30K
10	350	32	585	378	382	390	406	12	495	16	33	201	111	FF-350-32/30K
11	400	25	640	429	433	441	464	12	560	16	39	204	104	FF-400-25/30K
12	400	32	640	429	433	441	464	12	560	16	39	226	126	FF-400-32/30K

Disclaimer

Whilst every care is taken to ensure that the information on this website is complete and accurate, the Rotec Composite Group BV cannot accept responsibility for any omissions or inaccuracies or for any consequences arising therefrom. By using this website, the user accepts the terms of this disclaimer.

17-11-2022