

Rotec Stutzen

Flanschstutz

Drilling Standard: ANSI B16.5 Class 150, Resin Type: Derakane 470

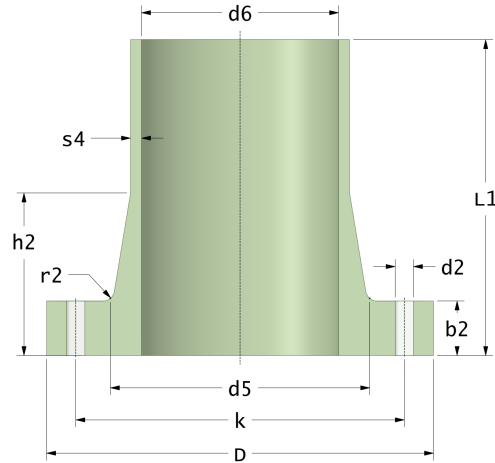

#	DN (mm)	Pmax (bar)	D (mm)	d6 (mm)	d5 (mm)	r2 (mm)	s4 (mm)	k (mm)	Holes (no.)	d2 (mm)	L1 (mm)	h2 (mm)	b2 (mm)	Article Number
1	15	16	98	15	35	1	4	61	4	16	200	25	12	TFC-15-200/150
2	20	16	98	20	42	1	4	70	4	16	200	25	13	TFC-20-200/150
3	25	16	116	25	50	1	4	79	4	16	250	30	14	TFC-25-250/150
4	32	16	116	32	62	1	5	89	4	16	250	35	15	TFC-32-250/150
5	40	16	150	40	68	1	5	98	4	16	300	40	16	TFC-40-300/150
6	50	16	164	50	82	1	5	121	4	19	300	40	18	TFC-50-300/150
7	65	16	184	65	95	1	5	140	4	19	300	50	20	TFC-65-300/150
8	80	16	200	80	111	2	6	152	4	19	300	50	22	TFC-80-300/150
9	100	16	228	100	133	2	6	190	8	19	300	55	25	TFC-100-300/150
10	125	16	254	125	160	2	6	216	8	22	300	65	27	TFC-125-300/150
11	150	16	284	150	188	3	6	241	8	22	300	70	30	TFC-150-300/150
12	200	10	342	200	237	4	6	298	8	22	360	85	25	TFC-200-360/150
13	250	10	419	254	284	5	9.5	362	12	25	305	102	30	TFC-250-300/150
14	300	10	495	305	341	6	11.1	432	12	25	305	127	36	TFC-300-300/150
15	350	10	546	356	394	7	12.7	476	12	29	305	152	45	TFC-350-300/150
16	400	6	610	406	448	8	14.3	540	16	29	305	152	41	TFC-400-300/150
17	450	6	648	457	502	8	15.9	578	16	32	305	178	44	TFC-450-300/150
18	500	6	711	508	556	8	17.5	635	20	32	305	178	48	TFC-500-300/150

Disclaimer

Whilst every care is taken to ensure that the information on this website is complete and accurate, the Rotec Composite Group BV cannot accept responsibility for any omissions or inaccuracies or for any consequences arising therefrom. By using this website, the user accepts the terms of this disclaimer.